

Notes:

- 1) All dimensions in inches.
- 2) Hot dip galvanized per ASTM A153.

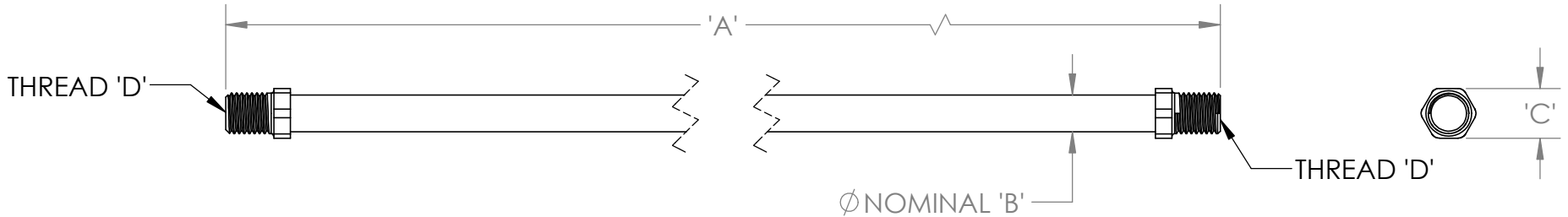

PART NUMBER	'A'	'B'	'C'	'D'	GUY EYE PART NUMBER INCLUDED	WEIGHT (LBS)	ULTIMATE STRENGTH
G6231/2	3-1/2'	5/8"	1"	43/64"-11 UNS	NONE INCLUDED	3.5	16,000
G6231/2S	3-1/2'	5/8"	1"	43/64"-11 UNS	G6510A	4.5	16,000
G6231/2D	3-1/2'	5/8"	1"	43/64"-11 UNS	G6560A	5.5	16,000
G62	7'	5/8"	1"	43/64"-11 UNS	NONE INCLUDED	6.5	16,000
G62S	7'	5/8"	1"	43/64"-11 UNS	G6510A	7.5	16,000
G62D	7'	5/8"	1"	43/64"-11 UNS	G6560A	8.5	16,000
G7531/2	3-1/2'	3/4"	1.23"	1"-8 UNC	NONE INCLUDED	5	23,000
G7531/2S	3-1/2'	3/4"	1.23"	1"-8 UNC	G6512	7	23,000
G7531/2D	3-1/2'	3/4"	1.23"	1"-8 UNC	G6562A	7	23,000
G75	7'	3/4"	1.23"	1"-8 UNC	NONE INCLUDED	9.5	23,000
G75S	7'	3/4"	1.23"	1"-8 UNC	G6512	11.5	23,000
G75D	7'	3/4"	1.23"	1"-8 UNC	G6562A	11.5	23,000
G10031/2	3-1/2'	1"	1.23"	1"-8 UNC	NONE INCLUDED	9.5	36,000
G10031/2S	3-1/2'	1"	1.23"	1"-8 UNC	G6512	11.5	36,000
G10031/2D	3-1/2'	1"	1.23"	1"-8 UNC	G6562A	11.5	36,000
G100	7'	1"	1.23"	1"-8 UNC	NONE INCLUDED	18	36,000
G100S	7'	1"	1.23"	1"-8 UNC	G6512	20	36,000
G100D	7'	1"	1.23"	1"-8 UNC	G6562A	20	36,000

Unless otherwise noted:
 All dimensions are in inches
 Degrees: +/- 5.0
 0 place decimal: +/- 0.1
 1 place decimal: +/- 0.01
 2 place decimal: +/- 0.03

B	4/9/2024	151
A	1/25/2023	-
REV	REV DATE	ECR #



MATERIAL: Ø9/16", or Ø0.68", or Ø0.91"
 Round Steel Bar Per ASTM 1045

POWER-GRIP HUB ANCHOR ROD

P/N: POWER-GRIP HUB ANCHOR ROD - DATASHEET

WEIGHT: SEE TABLE

Date: 1/25/2023

DRAWN BY: JM

Rev: B